

# International Share House Flat Bolero Jodoji

Address : 4-1 Kamibanbacho Jodoji Sakyo-ku Kyoto city, Kyoto, Japan

## Come live with us

- A quiet Kita-Shirakawa area where Kyoto people want to live at least once
- International designers house newly built by a architect who worked on the design of the Awaji Westin Hotel, etc. (2017/10)
- A fulfilling common space. A comfortable house with a good atmosphere to respect the values and privacy for multinationals.
- Also good for those who are looking for "a bit nicer place" and "modern design room" with reasonable monthly rent.
- Cleaning company regularly cleans common area. Reset where you can't handle. Even if you are new to share house, you can frankly join.



**Rent : ¥48,000 - ¥49,000 (/month)**  
**Less than 6months: +¥2,000 (/month)**

- **Common Fee : ¥13,500 (/month)**
- **Managing/Cleaning at moving-out: ¥30,000**
- **Deposit (refundable): ¥20,000**
- **Fire Insurance: ¥8,000**
- **Male/Female 10 Private Rooms (with LOFT)**
- **Fully Furnished. Entrance with smart locked security**

## Area Profile

- There are sightseeing spots representing Kyoto, such as the Philosophy Road and Ginkakuji Temple on foot, You can enjoy the seasonal life of Kyoto
- 1 minute walk from Jodoji bus stop. 15 minutes by bus to Central area (Karasuma / Kawaramachi), about 20 minutes by bicycle
- Convenience store and supermarket within 3 minutes walk (open 24 hours)
- The environment for living is in place



# Floor Layout

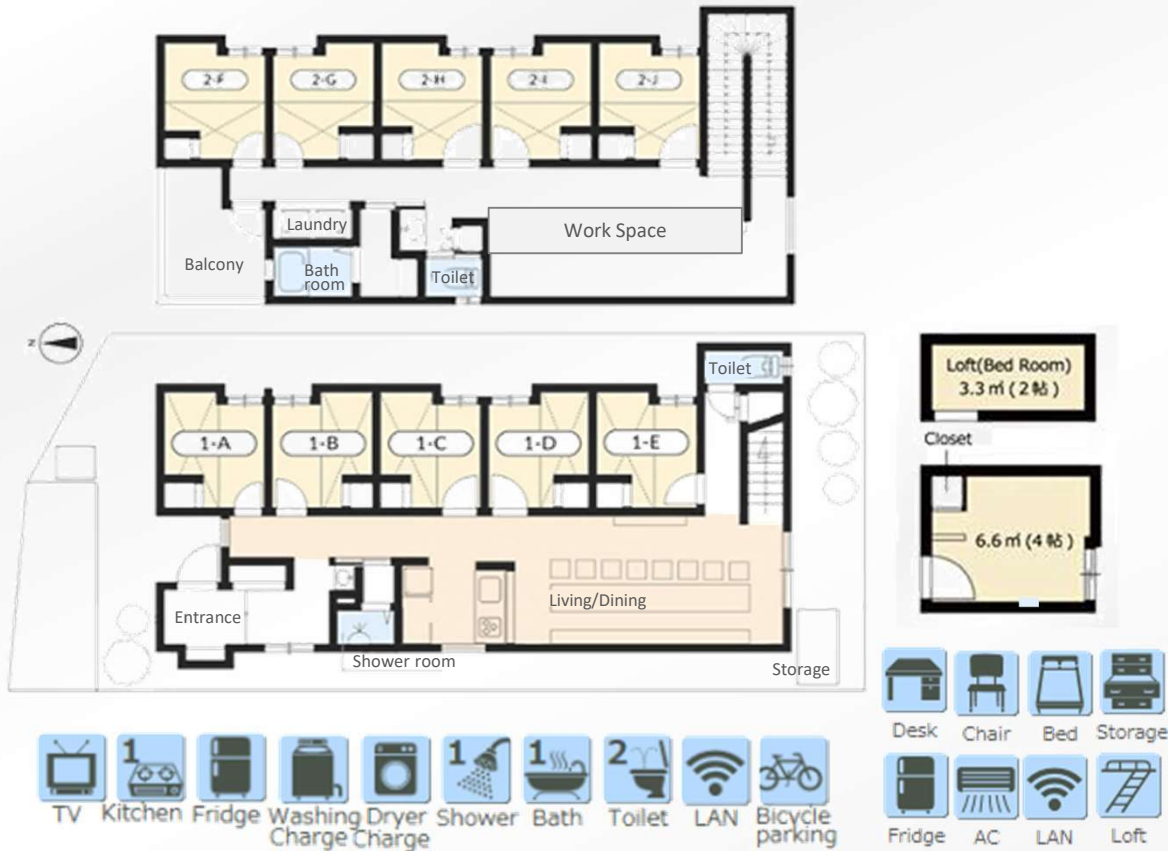

Initial Cost	
Management Fee	20,000JPY
Cleaning at moving-out	10,000JPY
Deposit	20,000JPY
Fire Insurance	8,000JPY
Monthly Rent ( Days)	JPY
Common Fee ( Days)	JPY
<b>TTL</b>	<b>JPY</b>

Monthly Cost	
Monthly Rent	JPY
Common Fee (Water, Electricity, Gas, WiFi, Common expendables)	JPY
<b>TTL</b>	<b>JPY</b>

## Management Style

- Host : ~1visits/month
- Cleaning : Cleaner visits Biweekly  
※Tenants take care trash
- No Smoking
- Notify friends' stay-over
- House rules stated

